

Instruction for multithread sensor SMG 156

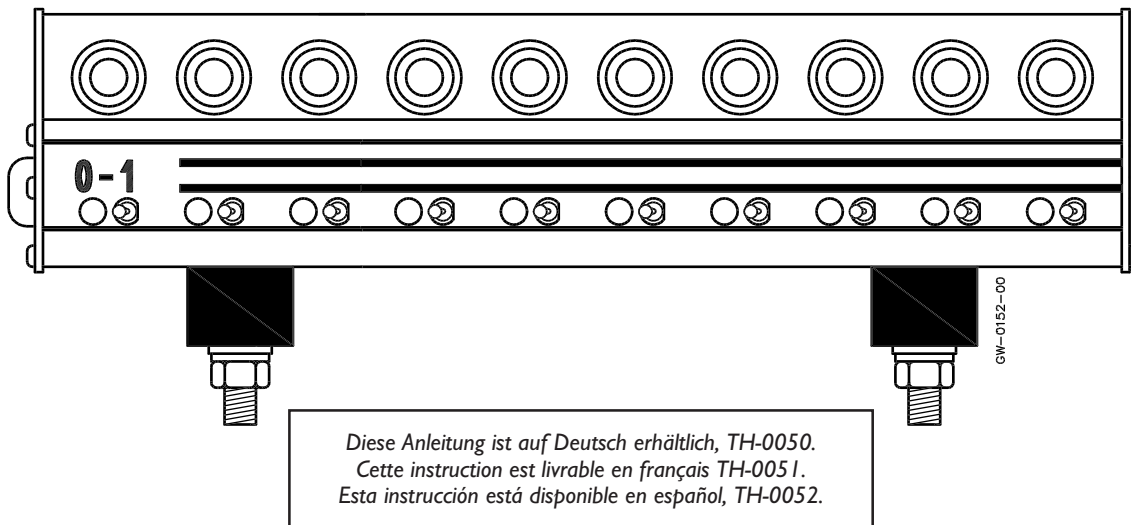

Diese Anleitung ist auf Deutsch erhältlich, TH-0050.
Cette instruction est livrable en français TH-0051.
Esta instrucción está disponible en español, TH-0052.

Fitting

The thread sensor must be fitted so that the threads or wires are touching the eyelets continuously. The movement will be best detected, if the thread or wire deviates about 10–15° when it passes through the thread sensor eyelet. A thread guide can be fitted to ensure this deviation.

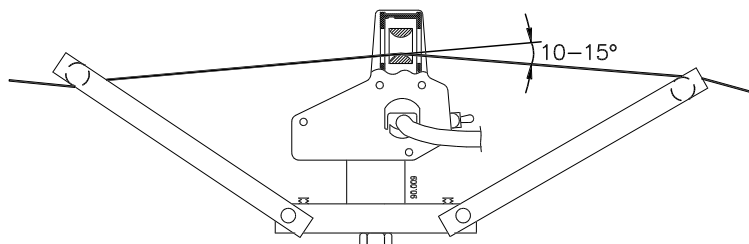

Connection

* If connection is made via screw terminal, the lid must first be opened. See instructions on next side.

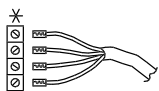
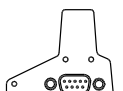
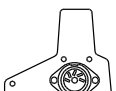
				
⊥ Earth	4	Black	9	3
Gain 0 V (Low) – 6,5 V (High)	3	Blue	5	5
Signal Normal 0 V Stop 12 V	2	Grey	1	2
+24 V DC (15 – 33 V DC)	1	Red	6	1

The signal amplification "Gain" is set with a potentiometer in the central control unit. Please refer to the instruction for the central control unit you are using.

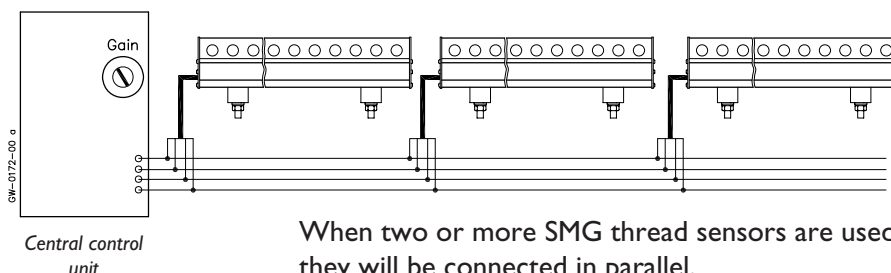

When two or more SMG thread sensors are used, they will be connected in parallel.

How to open and close the lid

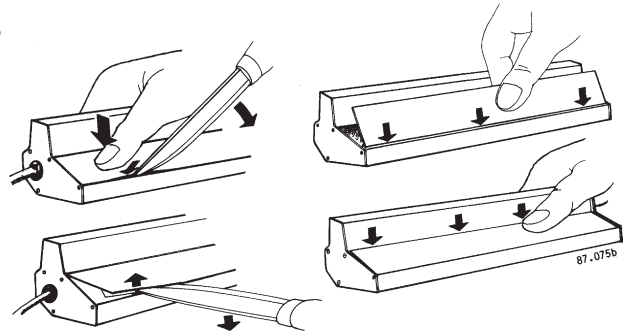

Reaction time (Drop-out time)

Depending on type, speed, tension, etc of the detected thread or wire, the signal from the eyelet can be irregular and cause false stops. The false stops can be avoided by increasing the reaction time. When it is important that the stop occurs very quickly after a thread or wire failure, it is necessary to decrease the reaction time.

To set the reaction time:

Open the lid.

Locate the 2 x 9 pole pin strip with the connection shunt.

Set the shunt in the desired position.

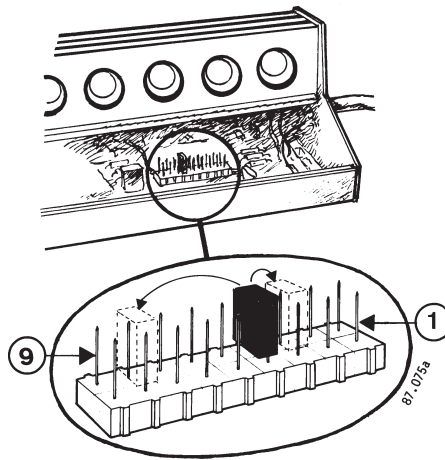

Position	Approximate reaction time (ms)
1	8
2	17
3	26
4	35 *
5	44
6	53
7	62
8	71
9	80

* = Standard setting

Switches and LED's

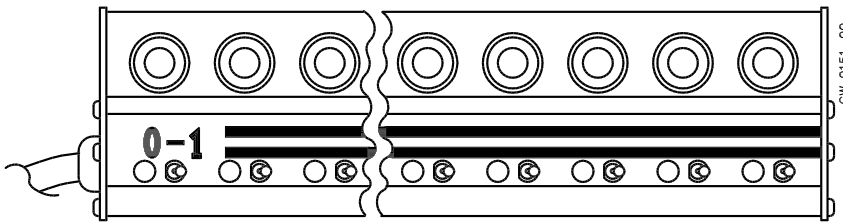

Individual switches

Each eyelet is equipped with a switch for switching that eyelet on or off.

A red LED beside the switch indicates when the eyelet has detected a fault.

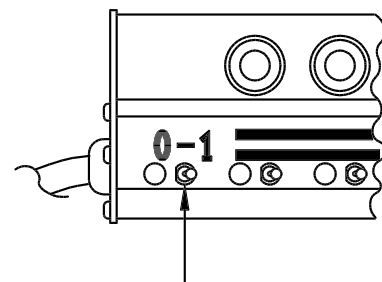

Master switch

Some SMG thread sensors are equipped with a master switch. With this switch the entire thread sensor can be switched off. A green LED beside the master switch is on, when the thread sensor is switched on (active).



Box 24 • SE-283 21 OSBY • Sweden • Tel. +46 479 53 63 00 • Fax +46 479 53 63 99
E-mail: info@eltex.se • Web: www.eltex.se

ELTEX U.S. INC.
13031 E. Wade Hampton Blvd
Greer, SC 29651
USA
Tel: 864-879-2131
In U.S. tollfree: 1-800-421-1156
Fax: 864-879-3734
Email: sales@eltexus.com

ELTEX MFG LTD
Railway Road
Templemore, Co. Tipperary
Ireland
Tel: 504-314 33
Fax: 504-310 02
Email: info@eltex.ie

POLSA-ELTEX S.L.
Zamora, 103 - entlo 3
ES-08018 Barcelona
Spain
Tel: 093-309 00 17
Fax: 093-309 59 45
Email: polsa@infonegocio.com